

Built of material (liste des matières)

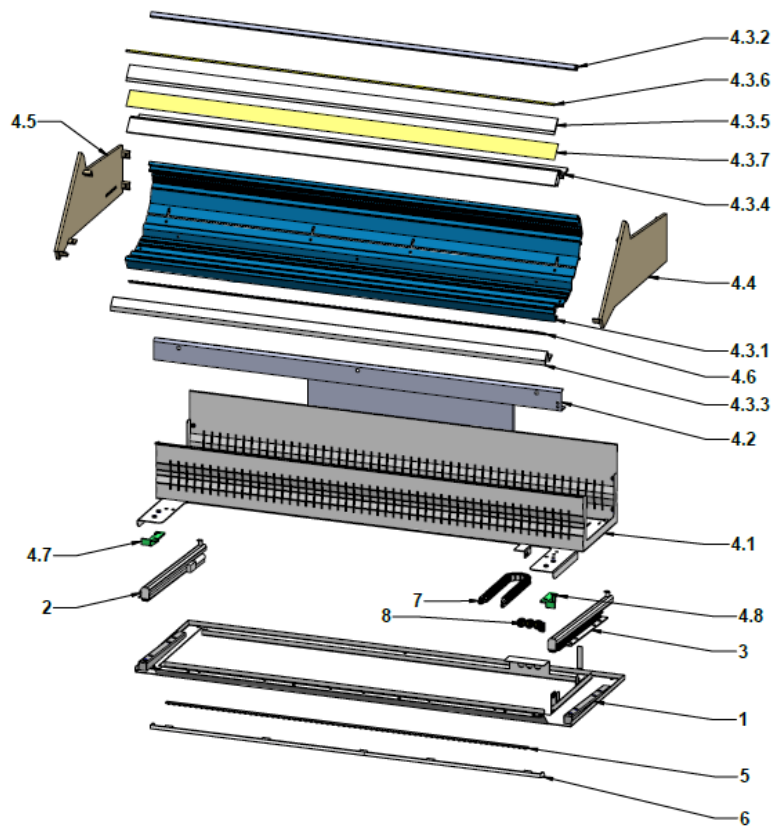

ITEM NO.	PART NUMBER	PART DESCRIPTION	QTY.	MATERIAL	WEIGHT(GR)
1	55012-1517-001	BASE METAL STRUCTURE	1	SHEETMETAL	1760.798
2	SLIDER LEFT	300MM SLIDER - LEFT	1	SHEETMETAL	470.00
3	SLIDER RIGHT	300MM SLIDER - RIGHT	1	SHEETMETAL	470.00
4.1	55012-2527-001	DRAWER METAL STRUCTURE	1	SHEETMETAL	3814.90
4.2	55007-2004-815	SUPPORT ALUMINUM-815MM	1	ALUMINUM	280.15
4.3	55009-0118-860	860MM PROFILES ASSEMBLY	1	ASSEMBLY STRUCTURE	3252.67
4.3.1	55007-2000-860	BIG FRONT EXTRUSION	1	ALUMINUM	2345.87
4.3.2	55007-1000-860	PART FOR MAGNETIC MODULE	1	SHEETMETAL	125.33
4.3.3	55007-2002-860	860 MM ESTEE LEAUDER DRAWER	1	ALUMINUM	385.86
4.3.4	55007-2003-007	PLASTIC EXTRUSION	1	PMMA	
4.3.5	55007-1005-860	TICKET STRIP COVER - 854 DRAWER	1	PMMA	86.84
4.3.6	55007-2500-860	GOLD BORDER	1	ABS	4.86
4.3.7	55007-1007-860	VISUAL PAPER	1	PAPER	6.71
4.4	55012-3000-001	CSP EMEA DRAWERS-RIGHT ENDCAP	1	ABS	213.25
4.5	55012-3001-001	CSP EMEA DRAWERS-LEFT ENDCAP	1	ABS	213.25
4.6	EL-LED-3511-0836	INNER LED	1	LED-PCB	29.75
4.7	55012-3002-001	SLIDER CATCHER LEFT	1	PA 66	5.58
4.8	55012-3003-001	SLIDER CATCHER RIGHT	1	PA 66	5.58
4.9	55007-2005-856	ALUMINIUM MOUNTING PART	1	ALUMINUM	242.12
5	EL-LED-3510-0726	DOWNLIGHTING LED	1	LED-PCB	
6	45001-1015-001	DOWNLIGHTING DIFFUSER	2	PS	21.180
7	CABLE CARRIER	CABLE CARRIER CKS CK07 F007	1	PA6 WITH %30 FIBER GLASS	24.49
8	EL-ASM-0004	TRIPLE JACK	1	ELECTRICAL COMPONENT	6.65